

HANHUI™ 汉辉
—— 让光更完美

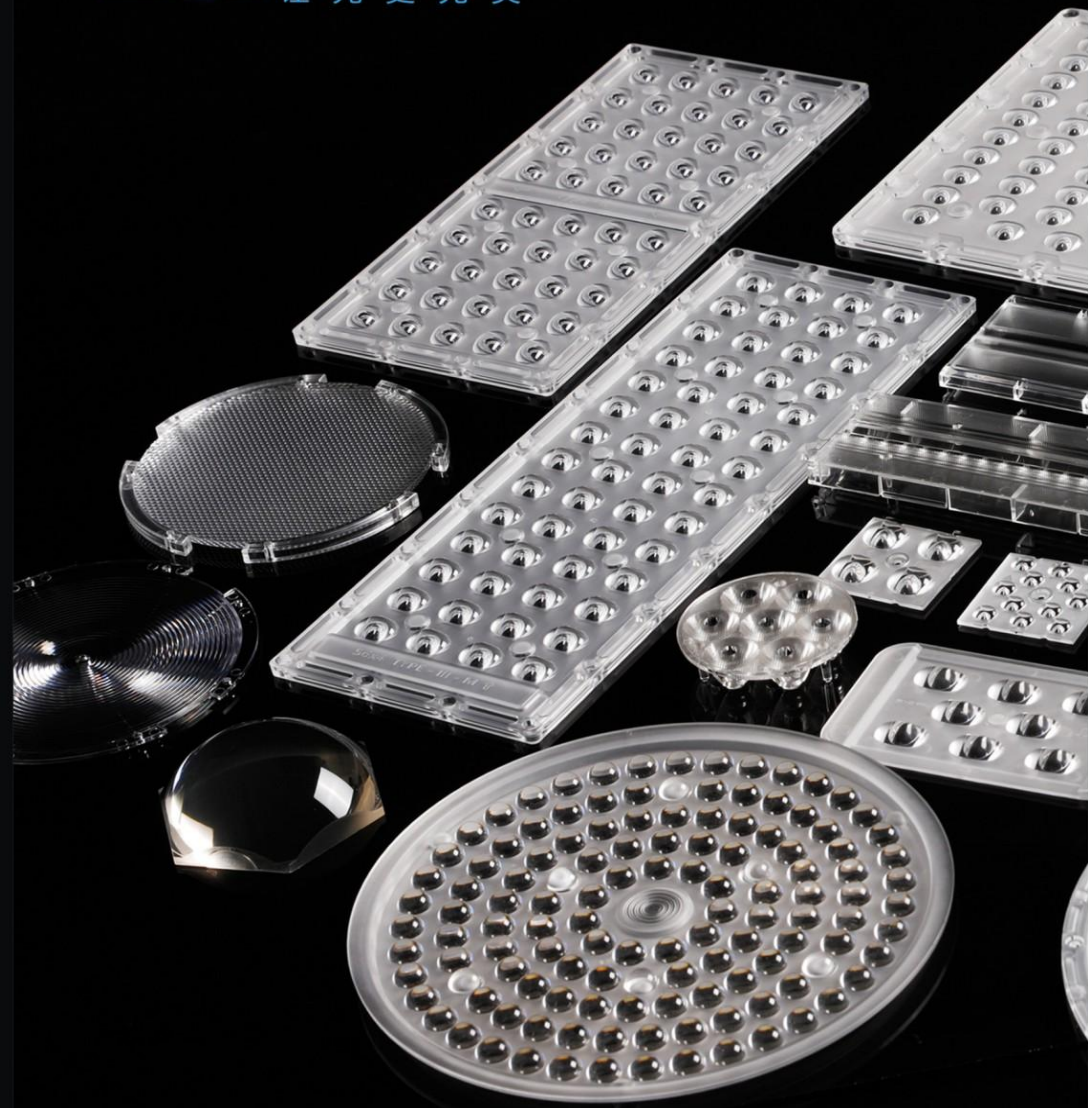

深圳市汉辉光电有限公司
shenzhen hanhui photoelectric co.,Ltd.

地址：深圳市宝安区石岩街道石龙仔社区恒昌荣高科技科技园3栋3楼
ADD: Area A No.3 Building 3th Floor,Hengchang Rong Industrial
park shiyan,shilong community,Bao'an District,shenzhen,china
TEL:86-755-29232420 FAX:86-755-83723765
<http://www.szhanhui.com> <http://linsen4880.1688.com>



深圳市汉辉光电有限公司
shenzhen hanhui photoelectric co.,Ltd.

关于我们 —

深圳市汉辉光电有限公司是一家集研发，设计，开模，生产销售为一体的实体企业。以精湛的技术设计和自动化专业制造以及严格的生产管理体系，提供LED室内外照明，激光投影，车灯等光学类产品服务，公司建立完善的ISO9001质量管理体系，均通过ROHS规格要求。

汉辉光电再光学透镜研发设计领域有自主知识产权的高新企业，在LED光学应用领域具有强大的开发和模具制造经验与能力。公司可以针对任何品牌的LED进行设计开发出专案理想的透镜，也会针对世界各大品牌开发出自己的产品并获得一些专利。目前开发出来的匹配CREE PHILIPS SSC PROLINHT HELIO EDISON EVERLIGE LG 等光源厂的单颗多颗连体等各尺寸规格专用透镜。

汉辉光电一直以产品质量为根本，原材料均采用环保光学级PMMA或V2-PC 户外专用的5VA-PC，并保证一次性使用，绝不添加和使用水口料。以优良的管理制度体系来保证产品质量。市场应用产品：路灯 天花灯 射灯 舞台灯 投光灯 洗墙灯 筒灯 手电 车载投影显示 鞋盒灯 仓库灯.....

公司秉承：品质第一，追求卓越，科技创新，诚信经营的理念，期待与您携手共创辉煌。

About us

Shenzhen Hanhui Photoelectric Technology Co., Ltd. Is a real enterprise integrating r&d, design, mold opening and production sales. By the exquisite design and automation professional manufacturing technology and strict production management system, and provide the LED indoor and outdoor lighting, laser projection, lights and other optical products services, the company set up perfect ISO9001 quality management system, passed ROHS specifications.

Hanhui Photoelectric In the field of optical lens development and design, there are high and new enterprises with independent intellectual property rights. In the field of LED optical applications, there are strong development and mold manufacturing experience and capability. The company can design and develop the ideal lens for the LED of any brand and develop its own products for the world's major brands and obtain some patents. At present, we have developed a special lens for each size specification, such as single multi-piece conjoined, etc., which match CREE PHILIPS SSC PROLINHT HELIO EDISON EVERLIGE LG.

Hanhui Photoelectric The product quality is always based on the environmental protection optical level PMMA or v2-pc outdoor special 5va-pc, and guaranteed to be used once, never add and use the water. Good management system to ensure product quality. Market application products: street lamps. Ceiling lamp. Shoot the light. The stage lights. Project-light lamp. Wash the wall lamp. Canister light. A torch. On-board projection display. Shoe lights. Warehouse lights

The company adheres to: quality first, the pursuit of excellence, scientific and technological innovation, the integrity management concept, looks forward to join hands with you to create brilliant.



一个品牌就是一份责任，一种信誉，一个保证
One brand means one responsibility, One credit and one assurance



认真是我们对客户的责任
Conscientiousness is our responsibility
to our customers.

认真是我们对工作的态度
Conscientiousness is our attitude
towards work.

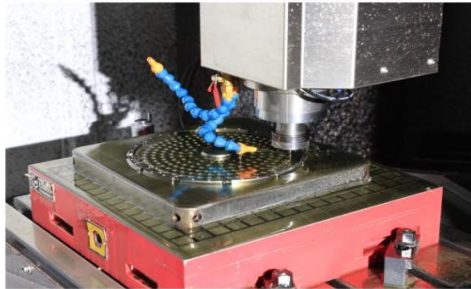

认真是我们生存的方式
Conscientiousness is the way we live.

**理念：我们本真共赢的态度，专业的
技术，为客户打造匠心的产品**
Philosophy: our true win-win attitude,
professional technology, for the customer to
build the products of ingenuity.

**工作我们是认真的，
服务我们是用心的**

We're serious about work,
The service is intentional.

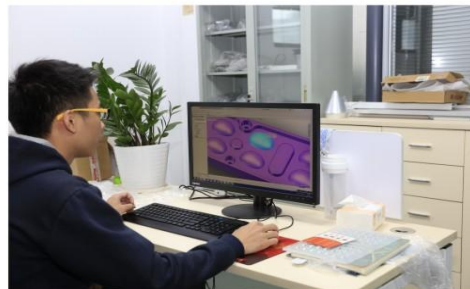

HH-38-52-60-SMD

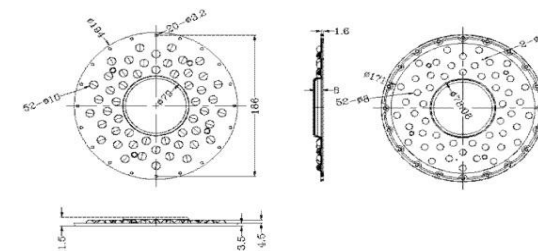

规格/ Specification: 194×8mm
 角度/ lens angle: 60°
 灯芯数/Wick: 52×1=52
 材料/Material: PC
 透过率/ Transmittance: 92%
 耐温/ Temperature: -35°C-120°C
 标准/Standard: SGS/ROHS
 适用LED型号/LED series: NICHIA / PHILIPS 3030/2835

HH-49-204-60-3030

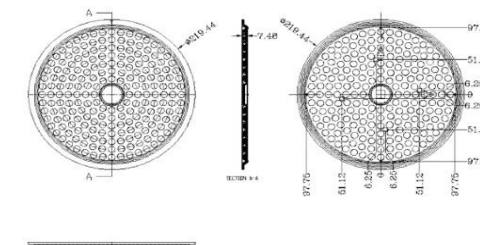

规格/ Specification: 220×7.48mm
 角度/ lens angle: 60°90°120°
 灯芯数/Wick: 204×1=204
 材料/Material: PC
 透过率/ Transmittance: 92%
 耐温/ Temperature: -35°C-120°C
 标准/Standard: SGS/ROHS
 适用LED型号/LED series: NICHIA / PHILIPS 3030/2835

HH-50-50-90-SMD

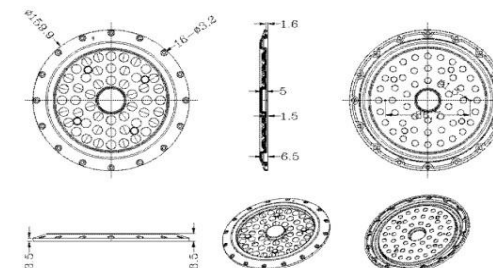

规格/ Specification: 160×8.5mm
 角度/ lens angle: 90°
 灯芯数/Wick: 50×1=50
 材料/Material: PC
 透过率/ Transmittance: 92%
 耐温/ Temperature: -35°C-120°C
 标准/Standard: SGS/ROHS
 适用LED型号/LED series: NICHIA / PHILIPS 5050/2835/3030

工矿灯-透镜
 Mining lamp - lens.

HH-65-150-45-3030

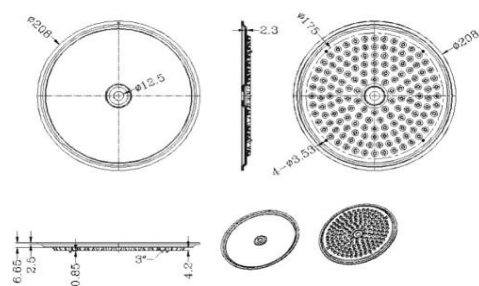

规格/ Specification: 208×11.7mm 透过率/ Transmittance: 92%
 角度/ lens angle: 45° 耐温/ Temperature: -35°C-120°C
 灯芯数/Wick: 150×1=150 标准/Standard: SGS/ROHS
 材料/Material: PC 适用LED型号/LED series: NICHIA / PHILIPS 3030/2835

HH-83-104-75-2835

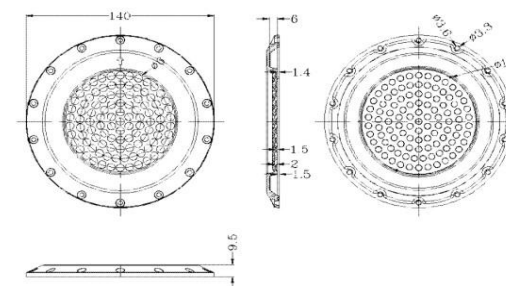

规格/ Specification: 140×9.5mm 透过率/ Transmittance: 92%
 角度/ lens angle: 75° 耐温/ Temperature: -35°C-120°C
 灯芯数/Wick: 104×1=104 标准/Standard: SGS/ROHS
 材料/Material: PC 适用LED型号/LED series: NICHIA / PHILIPS 3030/2835

HH-66-260-45-3030

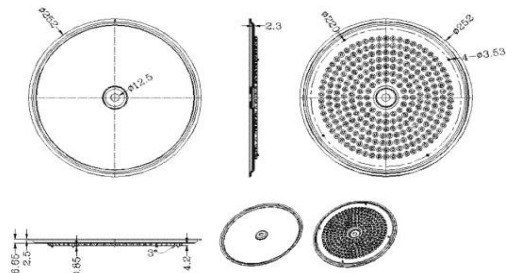

规格/ Specification: 252×11.7mm 透过率/ Transmittance: 92%
 角度/ lens angle: 45°/90° 耐温/ Temperature: -35°C-120°C
 灯芯数/Wick: 260×1=260 标准/Standard: SGS/ROHS
 材料/Material: PC 适用LED型号/LED series: NICHIA / PHILIPS 3030/2835

HH-84-156-60-2835

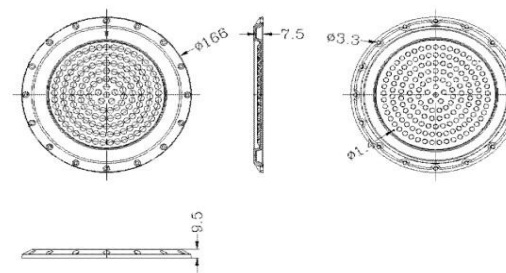

规格/ Specification: 166×9.5mm 透过率/ Transmittance: 92%
 角度/ lens angle: 60° 耐温/ Temperature: -35°C-120°C
 灯芯数/Wick: 156×1=156 标准/Standard: SGS/ROHS
 材料/Material: PC 适用LED型号/LED series: NICHIA / PHILIPS 3030/2835

HH-69-52-90-2835

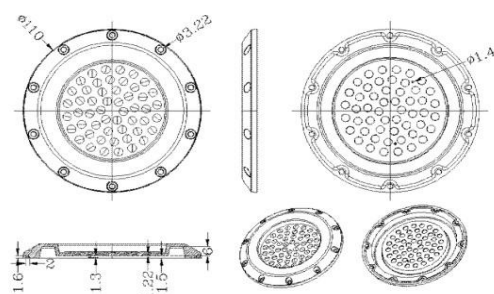

规格/ Specification: 110×9.5mm 透过率/ Transmittance: 92%
 角度/ lens angle: 90° 耐温/ Temperature: -35°C-120°C
 灯芯数/Wick: 52×1=52 标准/Standard: SGS/ROHS
 材料/Material: PC 适用LED型号/LED series: NICHIA / PHILIPS 3030/2835

HH-129-208-60-2835

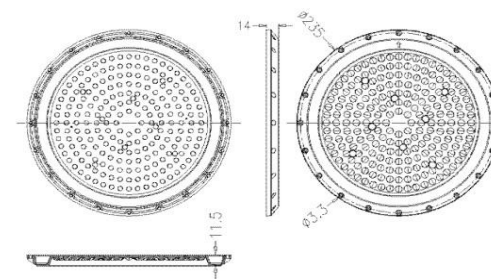

规格/ Specification: 235×14mm 透过率/ Transmittance: 92%
 角度/ lens angle: 60° 耐温/ Temperature: -35°C-120°C
 灯芯数/Wick: 208×1=208 标准/Standard: SGS/ROHS
 材料/Material: PC 适用LED型号/LED series: NICHIA / PHILIPS 3030/2835



规格/ Specification: 268×18mm
角度/ lens angle: 60°
灯芯数/Wick: 168×1=168 240×1=240
材料/Material: PC

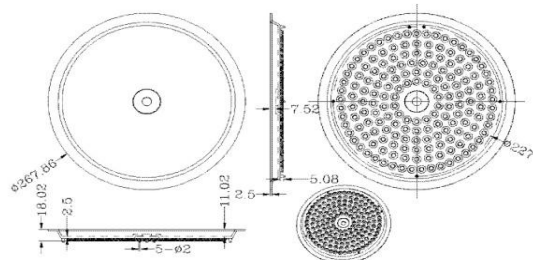

透过率/ Transmittance: 92%
耐温/ Temperature: -35°C-120°C
标准/Standard: SGS/ROHS
适用LED型号/LED series: NICHIA / PHILIPS 3030/2835



规格/ Specification: 339×14mm
角度/ lens angle: 60°90°
灯芯数/Wick: 483×1=483
材料/Material: PC

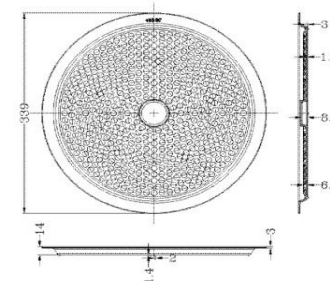

透过率/ Transmittance: 92%
耐温/ Temperature: -35°C-120°C
标准/Standard: SGS/ROHS
适用LED型号/LED series: NICHIA / PHILIPS 3030/2835



规格/ Specification: 351×17.82mm
角度/ lens angle: 60°
灯芯数/Wick: 270×1=270
材料/Material: PC

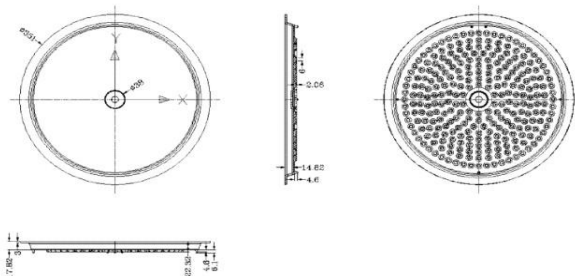

透过率/ Transmittance: 92%
耐温/ Temperature: -35°C-120°C
标准/Standard: SGS/ROHS
适用LED型号/LED series: NICHIA / PHILIPS 3030/2835



规格/ Specification: 270×16.98mm
角度/ lens angle: 60°
灯芯数/Wick: 252×1=252
材料/Material: PC

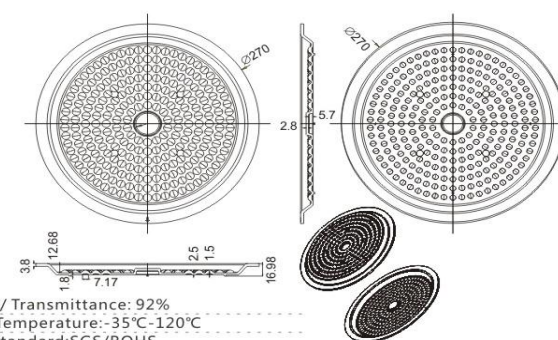

透过率/ Transmittance: 92%
耐温/ Temperature: -35°C-120°C
标准/Standard: SGS/ROHS
适用LED型号/LED series: NICHIA / PHILIPS 3030/2835



规格/ Specification: 339×14mm
角度/ lens angle: 60°
灯芯数/Wick: 376×1=376
材料/Material: PC

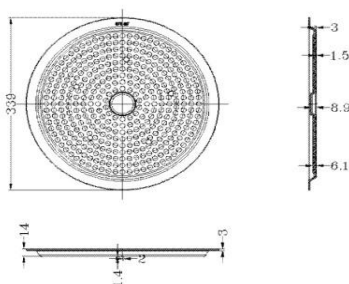

透过率/ Transmittance: 92%
耐温/ Temperature: -35°C-120°C
标准/Standard: SGS/ROHS
适用LED型号/LED series: NICHIA / PHILIPS 3030/2835



规格/ Specification: 217.5×8.2mm
角度/ lens angle: 50°80°
灯芯数/Wick: 336×1=336
材料/Material: PC

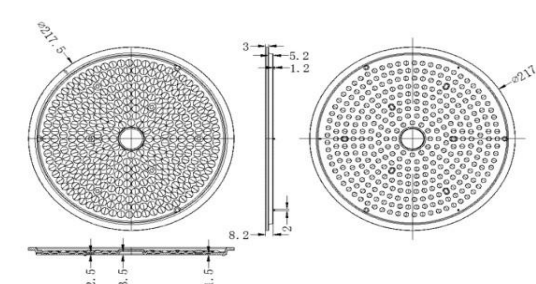

透过率/ Transmittance: 92%
耐温/ Temperature: -35°C-120°C
标准/Standard: SGS/ROHS
适用LED型号/LED series: NICHIA / PHILIPS 3030/2835

HH-142-714-80-3030

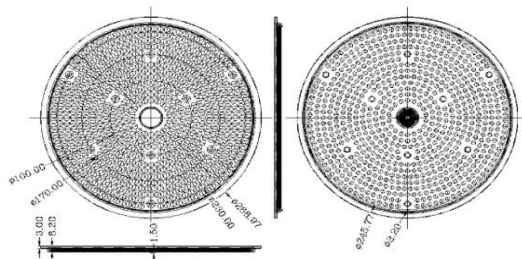

规格/ Specification: 269×8.2mm
角度/ lens angle: 80°50'30"
灯芯数/Wick: 714×1=714
材料/Material: PC

透过率/ Transmittance: 92%
耐温/ Temperature: -35°C-120°C
标准/Standard: SGS/ROHS
适用LED型号/LED series: NICHIA / PHILIPS 3030/2835

HH-171-121×4-60-3030

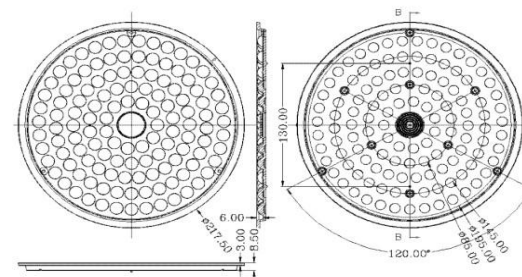

规格/ Specification: 217.5×8.5mm
角度/ lens angle: 60°90"
灯芯数/Wick: 121×4=484
材料/Material: PC

透过率/ Transmittance: 92%
耐温/ Temperature: -35°C-120°C
标准/Standard: SGS/ROHS
适用LED型号/LED series: NICHIA / PHILIPS 3030/2835

HH-101-350-60-3030

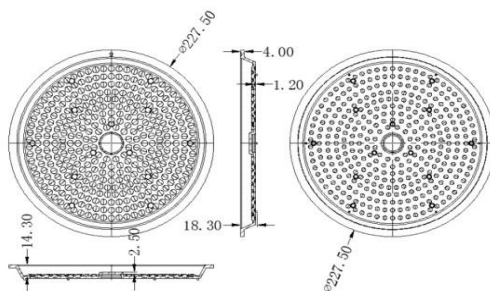

规格/ Specification: 227.5×18.3mm
角度/ lens angle: 60°80"
灯芯数/Wick: 350×1=350
材料/Material: PC

透过率/ Transmittance: 92%
耐温/ Temperature: -35°C-120°C
标准/Standard: SGS/ROHS
适用LED型号/LED series: NICHIA / PHILIPS 3030/2835

HH-175-217.5-PC罩

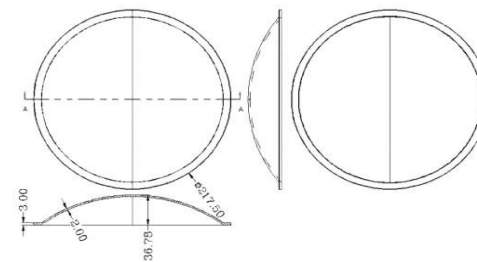

规格/ Specification: 217.5×36.78mm
角度/ lens angle: 60°90"
灯芯数/Wick: 121×4=484
材料/Material: PC

透过率/ Transmittance: 92%
耐温/ Temperature: -35°C-120°C
标准/Standard: SGS/ROHS
适用LED型号/LED series: NICHIA / PHILIPS 3030/2835

HH-102-476-60-3030

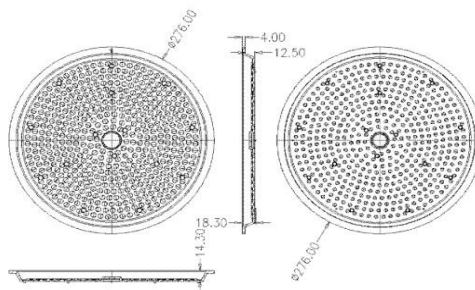

规格/ Specification: 276×18.3mm
角度/ lens angle: 60°80"
灯芯数/Wick: 476×1=476
材料/Material: PC

透过率/ Transmittance: 92%
耐温/ Temperature: -35°C-120°C
标准/Standard: SGS/ROHS
适用LED型号/LED series: NICHIA / PHILIPS 3030/2835

HH-182-105-45-5050

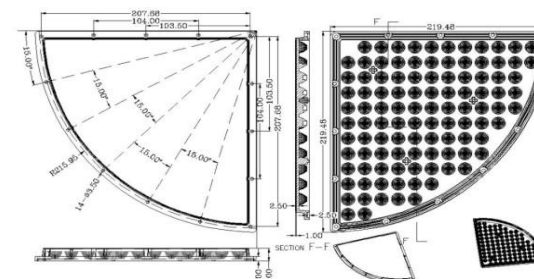

规格/ Specification: 219.48×219.48×14mm
角度/ lens angle: 45°
灯芯数/Wick: 336×1=105
材料/Material: PC

透过率/ Transmittance: 92%
耐温/ Temperature: -35°C-120°C
标准/Standard: SGS/ROHS
适用LED型号/LED series: PHILIPS 5050 CREE-XTE/XPL /3737

HH-192-210-60-3030

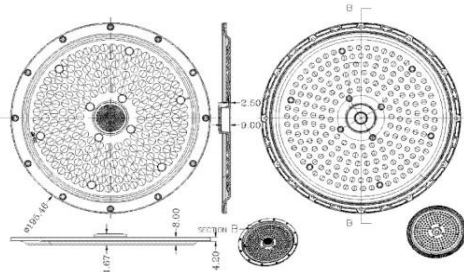

规格/ Specification: 195.5×11.67mm 透过率/ Transmittance: 92%
 角度/ lens angle: 60°90° 耐温/ Temperature: -35°C-120°C
 灯芯数/Wick: 210×1=210 标准/Standard: SGS/ROHS
 材料/Material: PC 适用LED型号/LED series: NICHIA / PHILIPS 3030/2835

HH-195-540-60-3030

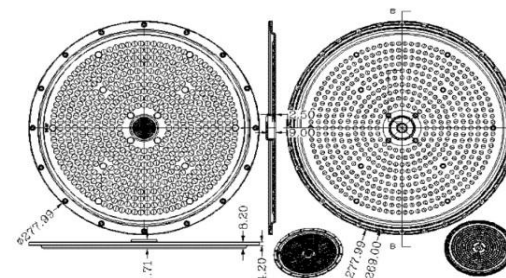

规格/ Specification: 278×11.71mm 透过率/ Transmittance: 92%
 角度/ lens angle: 60°90° 耐温/ Temperature: -35°C-120°C
 灯芯数/Wick: 540×1=540 标准/Standard: SGS/ROHS
 材料/Material: PC 适用LED型号/LED series: NICHIA / PHILIPS 3030/2835

HH-193-350-60-3030

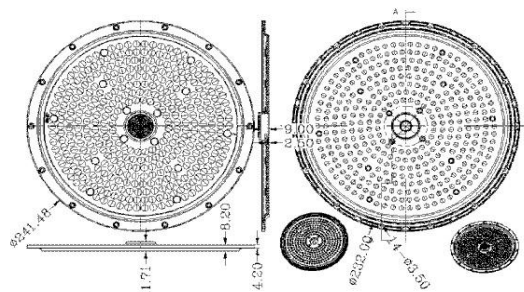

规格/ Specification: 241.5×11.71mm 透过率/ Transmittance: 92%
 角度/ lens angle: 60°90° 耐温/ Temperature: -35°C-120°C
 灯芯数/Wick: 350×1=350 标准/Standard: SGS/ROHS
 材料/Material: PC 适用LED型号/LED series: NICHIA / PHILIPS 3030/2835

HH-65A-150-60-3030

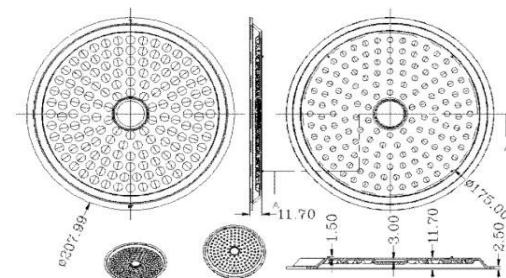

规格/ Specification: 208 mm 透过率/ Transmittance: 92%
 角度/ lens angle: 60°90° 耐温/ Temperature: -35°C-120°C
 灯芯数/Wick: 150×1=150 标准/Standard: SGS/ROHS
 材料/Material: PC 适用LED型号/LED series: NICHIA / PHILIPS 3030/2835

HH-194-420-60-3030

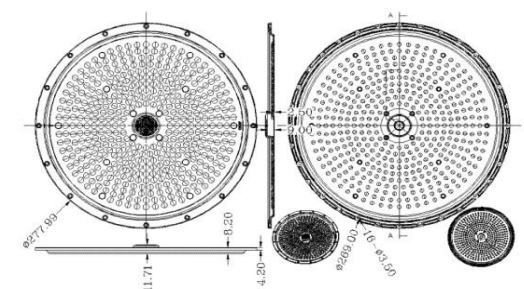

规格/ Specification: 278×11.71mm 透过率/ Transmittance: 92%
 角度/ lens angle: 60°90° 耐温/ Temperature: -35°C-120°C
 灯芯数/Wick: 420×1=420 标准/Standard: SGS/ROHS
 材料/Material: PC 适用LED型号/LED series: NICHIA / PHILIPS 3030/2835

HH-66A-260-60-3030

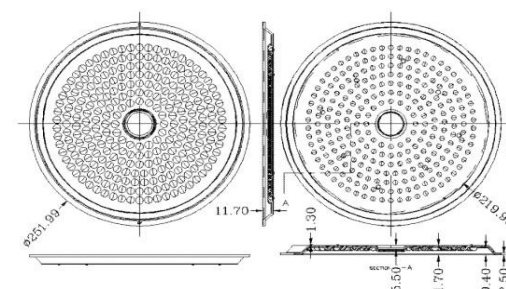

规格/ Specification: 252mm 透过率/ Transmittance: 92%
 角度/ lens angle: 60°90° 耐温/ Temperature: -35°C-120°C
 灯芯数/Wick: 260×1=260 标准/Standard: SGS/ROHS
 材料/Material: PC 适用LED型号/LED series: NICHIA / PHILIPS 3030/2835

HH-206-184-60-3030

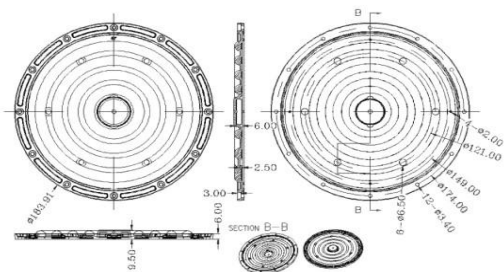

规格/ Specification: 184×9.5mm
角度/ lens angle: 60°90°120°
灯芯数/Wick: 不限
材料/Material: PC

透过率/ Transmittance: 92%
耐温/ Temperature: -35°C-120°C
标准/Standard: SGS/ROHS
适用LED型号/LED series: NICHIA / PHILIPS 3030/2835/5050

HH-207-226-60-3030

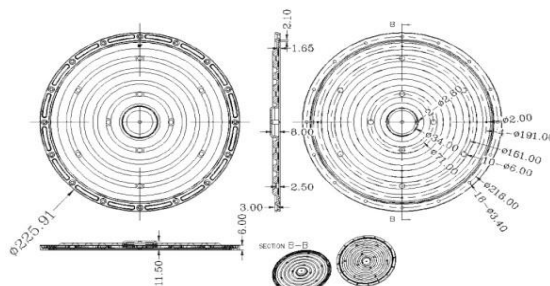

规格/ Specification: 226×11.5mm
角度/ lens angle: 60°90°120°
灯芯数/Wick: 不限
材料/Material: PC

透过率/ Transmittance: 92%
耐温/ Temperature: -35°C-120°C
标准/Standard: SGS/ROHS
适用LED型号/LED series: NICHIA / PHILIPS 3030/2835/5050

HH-208-265-60-3030

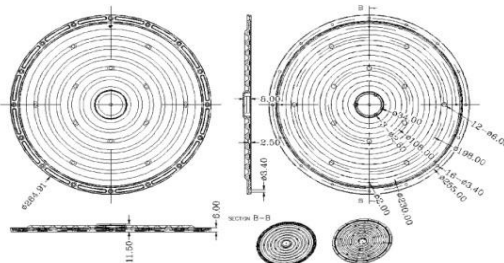

规格/ Specification: 265×11.5mm
角度/ lens angle: 60°90°120°
灯芯数/Wick: 不限
材料/Material: PC

透过率/ Transmittance: 92%
耐温/ Temperature: -35°C-120°C
标准/Standard: SGS/ROHS
适用LED型号/LED series: NICHIA / PHILIPS 3030/2835/5050

球场灯路灯透镜 stadium light street lamp lens.



HH-85-1×4-T2-S-3030

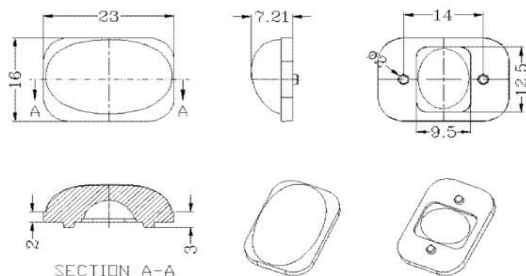

规格/ Specification: 23×16×7.21mm
角度/ lens angle: 85°155° (Type II-S)
灯芯数/Wick: 1×4=4
材料/Material: PC

透过率/ Transmittance: 92%
耐温/ Temperature: -35°C-120°C
标准/Standard: SGS/ROHS
适用LED型号/LED series: NICHIA / PHILIPS 3030

HH-93-12×1-55-3030

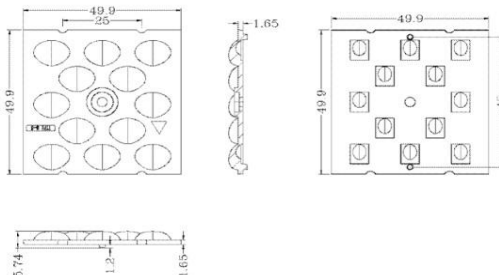
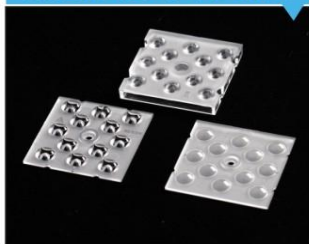

规格/ Specification: D×W 50×50mm
角度/ lens angle: 25°55°90°120° Type I (45°155° Type II-M)
(60°145° Type III-S) Type IV Type V
灯芯数/Wick: 12×1=12
材料/Material: PC

透过率/ Transmittance: 92%
耐温/ Temperature: -35°C-120°C
标准/Standard: SGS/ROHS
适用LED型号/LED series: NICHIA / PHILIPS 3030/2835

HH-109-4×1-30-5050

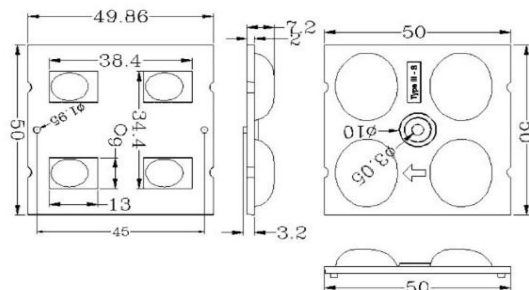

规格/ Specification: D×W 50×50mm
角度/ lens angle: 30°55°60°90° Type II
Type III-M Type IV Type V
灯芯数/Wick: 4×1=4
材料/Material: PC

透过率/ Transmittance: 92%
耐温/ Temperature: -35°C-120°C
标准/Standard: SGS/ROHS
适用LED型号/LED series: PHILIPS 5050

HH-116-4×4-T3-M-3030

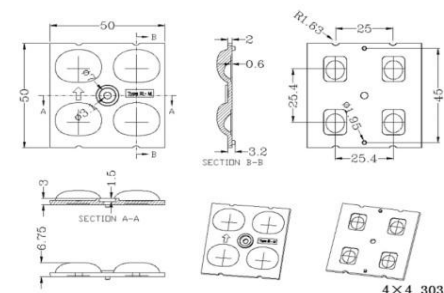

规格/ Specification: D×W 50×50mm
角度/ lens angle: 60°90°120° Type I Type II-M /L
Type III-M Type IV Type V
灯芯数/Wick: 4×4=16
材料/Material: PC

透过率/ Transmittance: 92%
耐温/ Temperature: -35°C-120°C
标准/Standard: SGS/ROHS
适用LED型号/LED series: NICHIA / PHILIPS 3030/2835

HH-115-8×1-30-7070

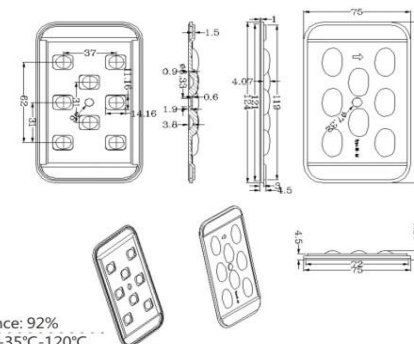

规格/ Specification: D×W 124×75mm
角度/ lens angle: 30°55° (Type III-M)
灯芯数/Wick: 8×1=8
材料/Material: PC

透过率/ Transmittance: 92%
耐温/ Temperature: -35°C-120°C
标准/Standard: SGS/ROHS
适用LED型号/LED series: SMD7070

HH-127-72×1-50-3030

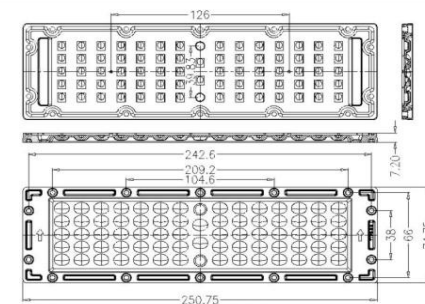

规格/ Specification: D×W 250×75mm
角度/ lens angle: 50°80°30°100° (80°150° Type III-M)
灯芯数/Wick: 72×1=72
材料/Material: PC

透过率/ Transmittance: 92%
耐温/ Temperature: -35°C-120°C
标准/Standard: SGS/ROHS
适用LED型号/LED series: NICHIA / PHILIPS 3030

HH-112-144×1-T3-M-3030

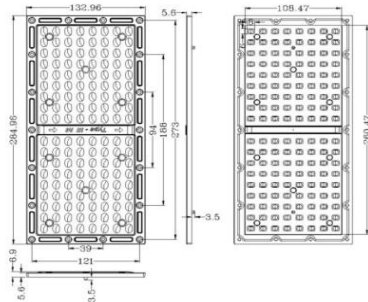
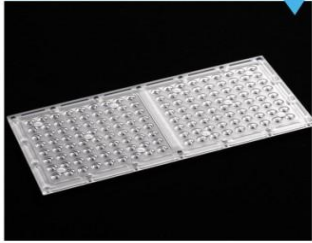

规格/ Specification: D×W×H 285×133×6.9mm
角度/ lens angle: Type II Type III-M Type IV-S Type V
灯芯数/Wick: 144×1=144
材料/Material: PC

透过率/ Transmittance: 92%
耐温/ Temperature: -35°C-120°C
标准/Standard: SGS/ROHS
适用LED型号/LED series: NICHIA / PHILIPS 3030

HH-80-126×1-30-3030

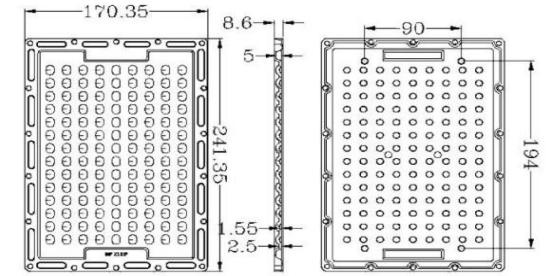
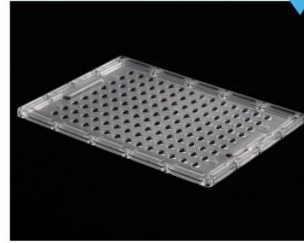

规格/ Specification: D×W×H 241.5×170.5×8.6mm
角度/ lens angle: 60°100°90°
灯芯数/Wick: 126×1=126
材料/Material: PC

透过率/ Transmittance: 92%
耐温/ Temperature: -35°C-120°C
标准/Standard: SGS/ROHS
适用LED型号/LED series: NICHIA / PHILIPS 3030

HH-105-56×2-T1-S-3030

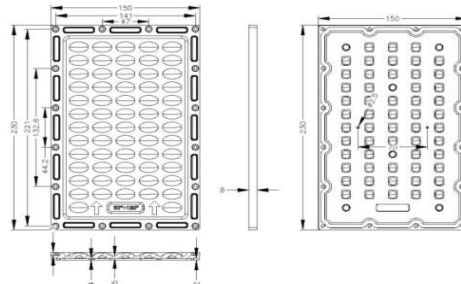
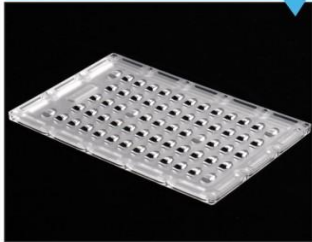

规格/ Specification: D×W×H 230×150×8mm
角度/ lens angle: Type I-S Type III-M Type V
灯芯数/Wick: 56×2=112
材料/Material: PC

透过率/ Transmittance: 92%
耐温/ Temperature: -35°C-120°C
标准/Standard: SGS/ROHS
适用LED型号/LED series: NICHIA / PHILIPS 3030

HH-33×1-60-5630

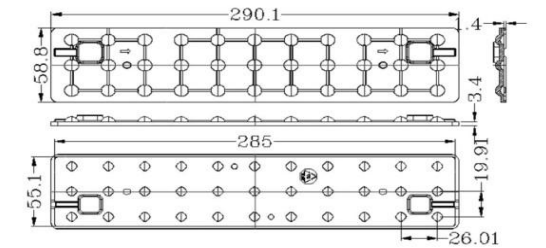

规格/ Specification: D×W 290×58.8mm
角度/ lens angle: 45°60°双偏光90°单偏光90°
灯芯数/Wick: 33×1=33
材料/Material: PC

透过率/ Transmittance: 92%
耐温/ Temperature: -35°C-120°C
标准/Standard: SGS/ROHS
适用LED型号/LED series: Samsung 5630, PHILIPS 3030

HH-64-96×1-60-3030

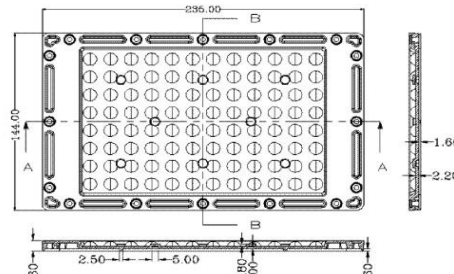
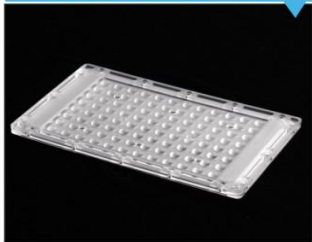

规格/ Specification: D×W×H 235×144×8.6mm
角度/ lens angle: 60°
灯芯数/Wick: 96×1=96
材料/Material: PC

透过率/ Transmittance: 92%
耐温/ Temperature: -35°C-120°C
标准/Standard: SGS/ROHS
适用LED型号/LED series: NICHIA / PHILIPS 3030

HH-120-80×1-60150-3030

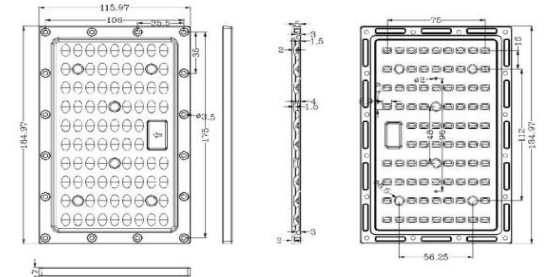

规格/ Specification: D×W×H 185×116×7mm
角度/ lens angle: 60°150°
灯芯数/Wick: 80×1=80
材料/Material: PC

透过率/ Transmittance: 92%
耐温/ Temperature: -35°C-120°C
标准/Standard: SGS/ROHS
适用LED型号/LED series: NICHIA / PHILIPS 3030

HH-118-80×1-60150-3030

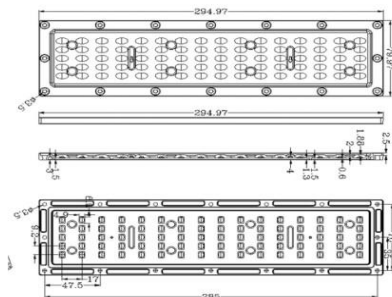

规格/ Specification: D×W×H 295×80×7mm
角度/ lens angle: 60°×150°
灯芯数/Wick: 80×1=80
材料/Material: PC

透过率/ Transmittance: 92%
耐温/ Temperature: -35°C-120°C
标准/Standard: SGS/ROHS
适用LED型号/LED series: NICHIA / PHILIPS 3030

HH-132-35×4-T2-3030

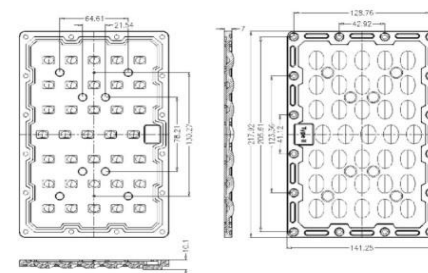

规格/ Specification: D×W×H 218×141×6.8mm
角度/ lens angle: 90° TypeII TypeIII TypeIV Type V
灯芯数/Wick: 35×4=140
材料/Material: PC

透过率/ Transmittance: 92%
耐温/ Temperature: -35°C-120°C
标准/Standard: SGS/ROHS
适用LED型号/LED series: NICHIA / PHILIPS 3030

HH-3×7-60-SMD

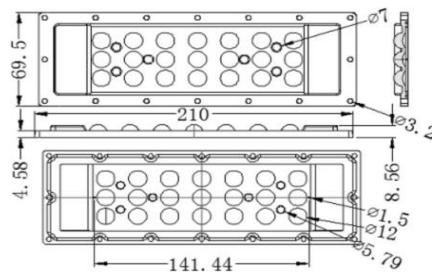

规格/ Specification: D×W×H 210×70×8.56mm
角度/ lens angle: 60°
灯芯数/Wick: 21×1=21
材料/Material: PC

透过率/ Transmittance: 92%
耐温/ Temperature: -35°C-120°C
标准/Standard: SGS/ROHS
适用LED型号/LED series: NICHIA / PHILIPS 3030 / 2835

HH-131-70×4-T2-3030

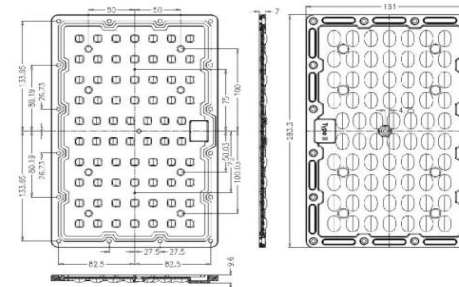
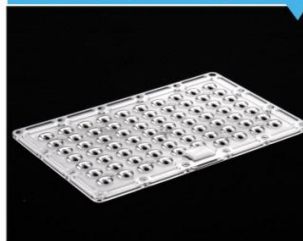

规格/ Specification: D×W×H 283×181×6.8mm
角度/ lens angle: 90° TypeII TypeIII TypeIV Type V
灯芯数/Wick: 70×4=280
材料/Material: PC

透过率/ Transmittance: 92%
耐温/ Temperature: -35°C-120°C
标准/Standard: SGS/ROHS
适用LED型号/LED series: NICHIA / PHILIPS 3030

HH-SM28-70150-3030

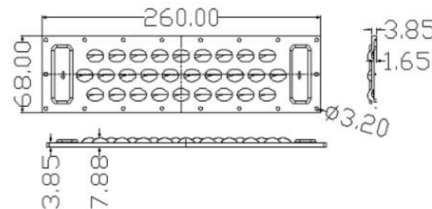

规格/ Specification: D×W×H 260×68×7.88mm
角度/ lens angle: 70°×150°
灯芯数/Wick: 28×1=28
材料/Material: PC

透过率/ Transmittance: 92%
耐温/ Temperature: -35°C-120°C
标准/Standard: SGS/ROHS
适用LED型号/LED series: SAMSUNG NICHIA / PHILIPS 3030

HH-130-105×4-T2-3030

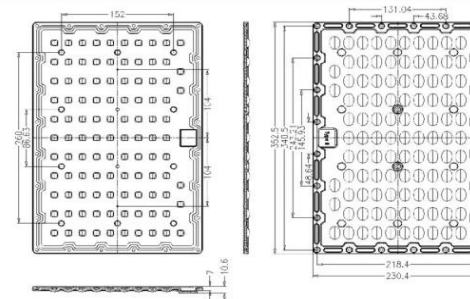
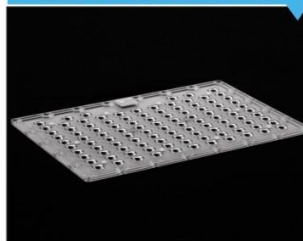

规格/ Specification: D×W×H 352.5×230.5×6.8mm
角度/ lens angle: 90° TypeII TypeIII TypeIV Type V
灯芯数/Wick: 105×4=420
材料/Material: PC

透过率/ Transmittance: 92%
耐温/ Temperature: -35°C-120°C
标准/Standard: SGS/ROHS
适用LED型号/LED series: NICHIA / PHILIPS 3030

HH-150-64×2-T2-S-3030

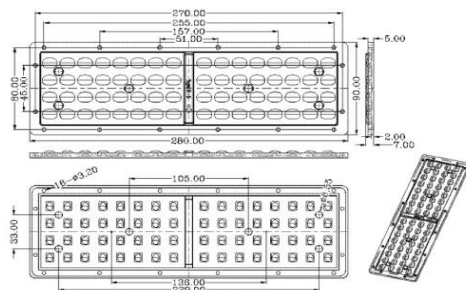

规格/ Specification: D×W×H 280×90×7mm
角度/ lens angle: Type II Type III Type IV Type V
灯芯数/Wick: 64×2=128
材料/Material: PC

透过率/ Transmittance: 92%
耐温/ Temperature: -35°C-120°C
标准/Standard: SGS/ROHS
适用LED型号/LED series: NICHIA / PHILIPS 3030

HH-146-12×4-T2-M-3030

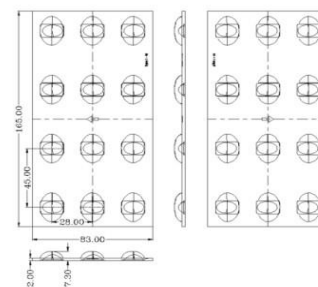

规格/ Specification: D×W×H 165×83×7.3mm
角度/ lens angle: Type II-M
灯芯数/Wick: 12×4=48
材料/Material: PC

透过率/ Transmittance: 92%
耐温/ Temperature: -35°C-120°C
标准/Standard: SGS/ROHS
适用LED型号/LED series: NICHIA / PHILIPS 3030

HH-105-42×4-T3-3030

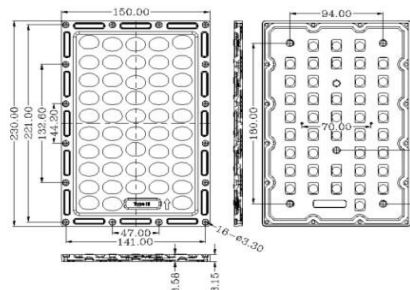

规格/ Specification: D×W×H 230×150×8.15mm
角度/ lens angle: Type III Type IV Type V
灯芯数/Wick: 42×4=168
材料/Material: PC

透过率/ Transmittance: 92%
耐温/ Temperature: -35°C-120°C
标准/Standard: SGS/ROHS
适用LED型号/LED series: NICHIA / PHILIPS 3030

HH-146-18×4-T2-M-3030

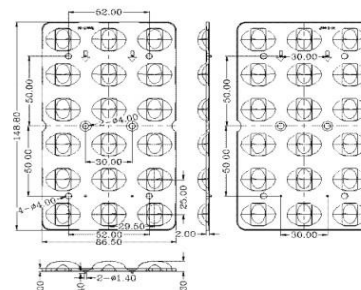

规格/ Specification: D×W×H 148.8×86.5×7.3mm
角度/ lens angle: Type II-M Type III-S Type III-M ×2
灯芯数/Wick: 18×4=72
材料/Material: PC

透过率/ Transmittance: 92%
耐温/ Temperature: -35°C-120°C
标准/Standard: SGS/ROHS
适用LED型号/LED series: NICHIA / PHILIPS 3030

HH-157-36×4-T3-3030

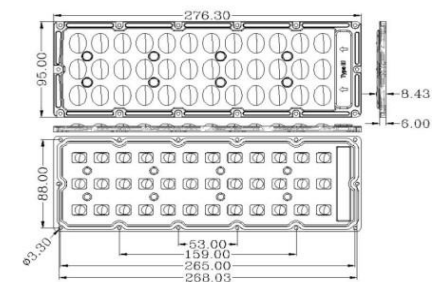

规格/ Specification: D×W×H 276.3×95×8.43mm
角度/ lens angle: Type III
灯芯数/Wick: 36×4=144
材料/Material: PC

透过率/ Transmittance: 92%
耐温/ Temperature: -35°C-120°C
标准/Standard: SGS/ROHS
适用LED型号/LED series: NICHIA / PHILIPS 3030

HH-166-24-T2-2835

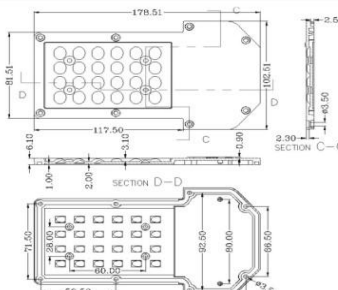

规格/ Specification: D×W×H 178.5×102.5×6.1mm
角度/ lens angle: Type II
灯芯数/Wick: 24×1=24
材料/Material: PC

透过率/ Transmittance: 92%
耐温/ Temperature: -35°C-120°C
标准/Standard: SGS/ROHS
适用LED型号/LED series: 2835/3030

HH-168-18×4-T2-M-3030

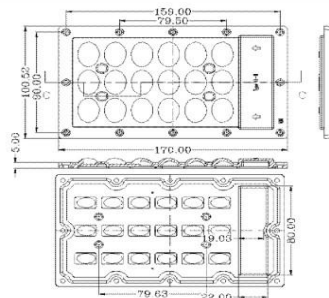

规格/ Specification: D×W×H 170×100.5×8.9mm
 角度/ lens angle: Type II-M
 灯芯数/Wick: 18×4=72
 材料/Material: PC

透过率/ Transmittance: 92%
 耐温/ Temperature: -35°C-120°C
 标准/Standard: SGS/ROHS
 适用LED型号/LED series: NICHIA / PHILIPS 3030

HH-213-22×4-T3-M-3030

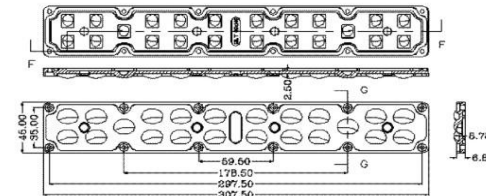

规格/ Specification: D×W×H 307.5×45×8.78mm
 角度/ lens angle: 60°90° Type I Type III-M
 灯芯数/Wick: 22×4=88
 材料/Material: PC

透过率/ Transmittance: 92%
 耐温/ Temperature: -35°C-120°C
 标准/Standard: SGS/ROHS
 适用LED型号/LED series: NICHIA / PHILIPS 3030

HH-209-50×4-T2-3030

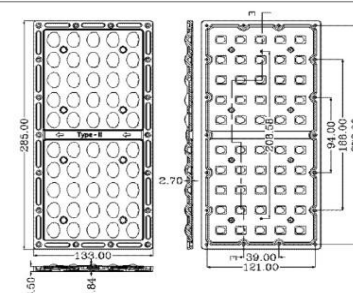

规格/ Specification: D×W×H 285×133×8.84mm
 角度/ lens angle: Type II Type III Type IV Type V
 灯芯数/Wick: 50×4=200
 材料/Material: PC

透过率/ Transmittance: 92%
 耐温/ Temperature: -35°C-120°C
 标准/Standard: SGS/ROHS
 适用LED型号/LED series: NICHIA / PHILIPS 3030

HH-214-20×4-T2-M-3030

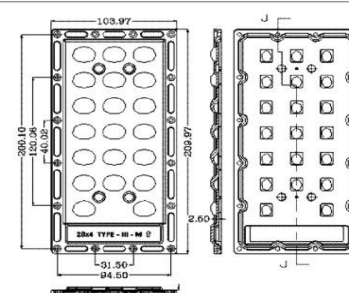

规格/ Specification: D×W×H 210×104×8.7mm
 角度/ lens angle: Type II Type III Type IV Type V 60°90°120°
 灯芯数/Wick: 20×4=80
 材料/Material: PC

透过率/ Transmittance: 92%
 耐温/ Temperature: -35°C-120°C
 标准/Standard: SGS/ROHS
 适用LED型号/LED series: NICHIA / PHILIPS 3030

HH-212-58×4-T2-M-3030

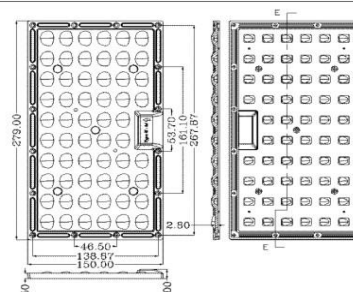

规格/ Specification: D×W×H 279×150×12mm
 角度/ lens angle: Type II Type III Type IV Type V
 灯芯数/Wick: 58×4=232
 材料/Material: PC

透过率/ Transmittance: 92%
 耐温/ Temperature: -35°C-120°C
 标准/Standard: SGS/ROHS
 适用LED型号/LED series: NICHIA / PHILIPS 3030

HH-215-32×4-T2-M-3030

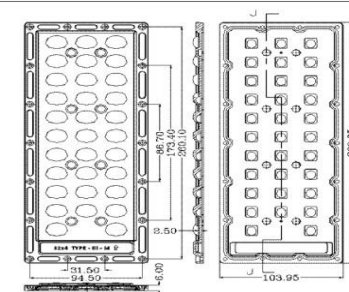

规格/ Specification: D×W×H 270×104×8.8mm
 角度/ lens angle: Type II Type III Type IV Type V 60°90°120°
 灯芯数/Wick: 32×4=128
 材料/Material: PC

透过率/ Transmittance: 92%
 耐温/ Temperature: -35°C-120°C
 标准/Standard: SGS/ROHS
 适用LED型号/LED series: NICHIA / PHILIPS 3030

HH-216-42×4-T2-M-3030

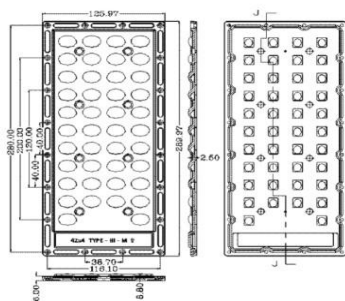

规格/ Specification: D×W×H 290×126×8.8mm

角度/ lens angle: TypeII TypeIII TypeIV TypeV 60°90°120°

灯芯数/Wick: 42×4=168

材料/Material: PC

透过率/ Transmittance: 92%

耐温/ Temperature: -35°C-120°C

标准/Standard: SGS/ROHS

适用LED型号/LED series: NICHIA / PHILIPS 3030

HH-217-56×4-T2-M-3030

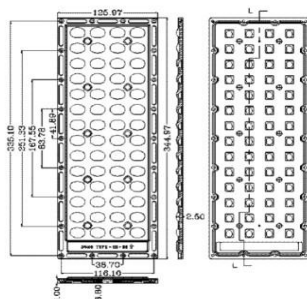
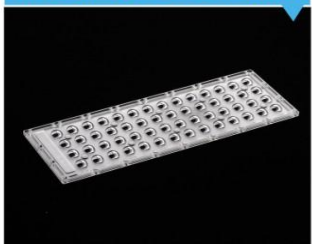

规格/ Specification: D×W×H 345×126×8.8mm

角度/ lens angle: TypeII TypeIII TypeIV TypeV 60°90°120°

灯芯数/Wick: 56×4=224

材料/Material: PC

透过率/ Transmittance: 92%

耐温/ Temperature: -35°C-120°C

标准/Standard: SGS/ROHS

适用LED型号/LED series: NICHIA / PHILIPS 3030

亮化透镜 Lighting lens

HH-36-FC-5050

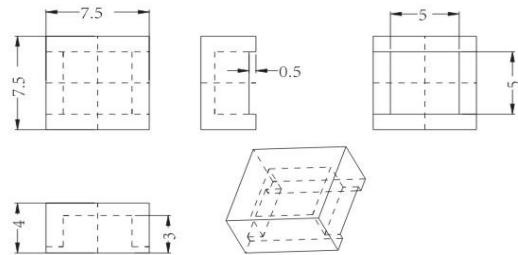
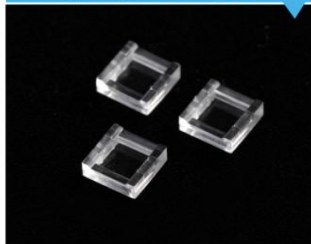

规格/ Specification: 7.5mm
角度/ lens angle: 120°
灯芯数/Wick: 1
材料/Material: PC

透过率/ Transmittance: 93%
耐温/ Temperature: -35°C-90°C
标准/Standard: SGS/ROHS
适用LED型号/LED series: 5050

HH-186-15-3090-3030

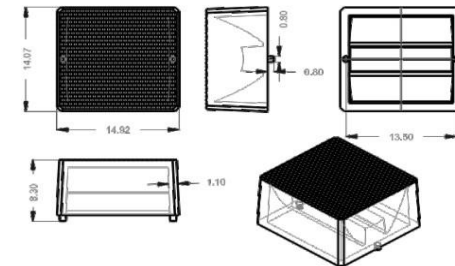
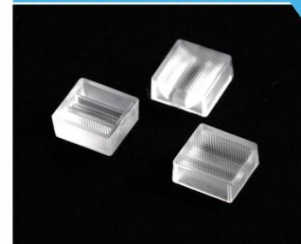

规格/ Specification: 15mm
角度/ lens angle: 30°×90°
灯芯数/Wick: 1
材料/Material: PMMA

透过率/ Transmittance: 93%
耐温/ Temperature: -35°C-90°C
标准/Standard: SGS/ROHS
适用LED型号/LED series: 3030

HH-32-15-30Z-5050

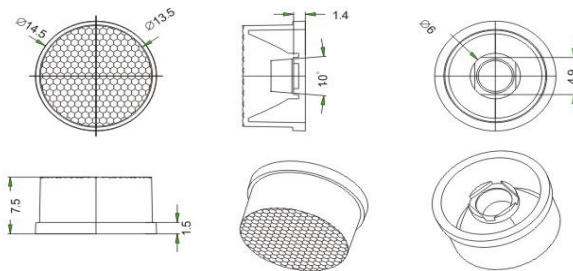

规格/ Specification: 14.5mm
角度/ lens angle: 30°45°60°20°50°
灯芯数/Wick: 1
材料/Material: PC

透过率/ Transmittance: 93%
耐温/ Temperature: -35°C-90°C
标准/Standard: SGS/ROHS
适用LED型号/LED series: 5050

HH-35-15-15F-XP-6B

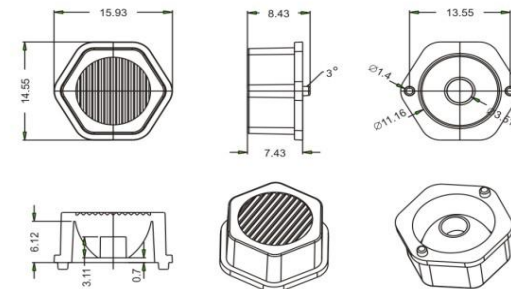

规格/ Specification: 15mm
角度/ lens angle: 15°25°45°10°60° 25°45°40°60°
灯芯数/Wick: 1
材料/Material: PMMA

透过率/ Transmittance: 93%
耐温/ Temperature: -35°C-90°C
标准/Standard: SGS/ROHS
适用LED型号/LED series: 3535 3030 2835

HH-53-15-30Z-XP

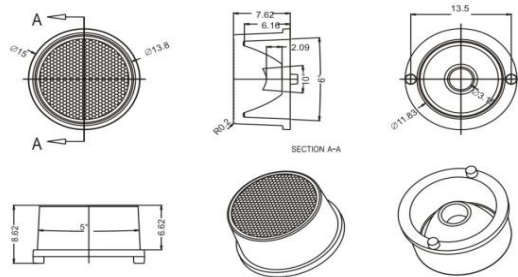

规格/ Specification: 15mm
角度/ lens angle: 15°30°45°60°10°60°25°60°
灯芯数/Wick: 1
材料/Material: PMMA

透过率/ Transmittance: 93%
耐温/ Temperature: -35°C-90°C
标准/Standard: SGS/ROHS
适用LED型号/LED series: 3030/ 3535/ 2835

HH-09-21.5-10G-XP

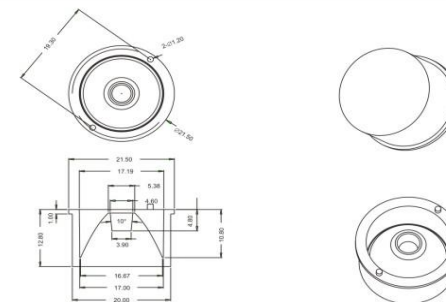

规格/ Specification: 21.5mm
角度/ lens angle: 10°20°30°10°60°30°60°
灯芯数/Wick: 1
材料/Material: PC/PMMA

透过率/ Transmittance: 93%
耐温/ Temperature: -35°C-120°C
标准/Standard: SGS/ROHS
适用LED型号/LED series: 3535 3030

HH-03-1215G-XP

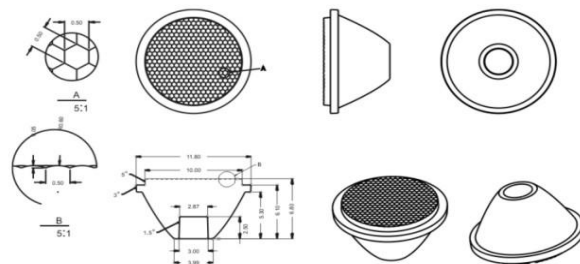

规格/ Specification: 11.8mm
 角度/ lens angle: 10°15°30°45° 60°10×60° 30×60°
 灯芯数/Wick: 1
 材料/Material: PMMA
 透过率/ Transmittance: 93%
 耐温/ Temperature: -35°C-90°C
 标准/Standard: SGS/ROHS
 适用LED型号/LED series: 3535/3030

HH-57-21.8-30G

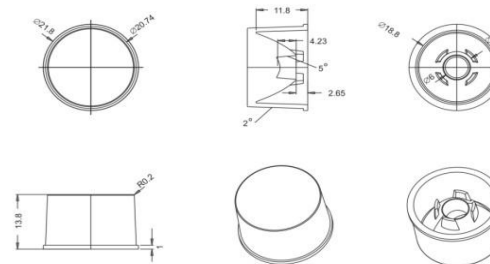

规格/ Specification: 21.8mm
 角度/ lens angle: 15°30°45° 60°15×50° 30×60°
 灯芯数/Wick: 1
 材料/Material: PC
 透过率/ Transmittance: 93%
 耐温/ Temperature: -35°C-120°C
 标准/Standard: SGS/ROHS
 适用LED型号/LED series: 仿流明

HH-P15-10G-XP

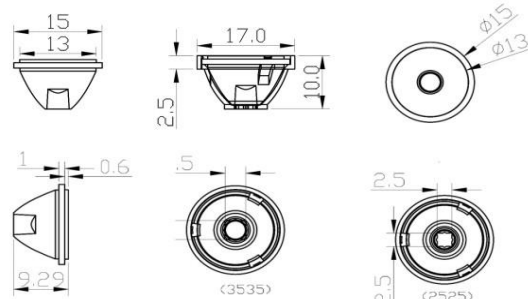

规格/ Specification: 15mm
 角度/ lens angle: 10°15°30°45° 60°70°10×60 15×50°30×60°
 灯芯数/Wick: 1
 材料/Material: PMMA
 透过率/ Transmittance: 93%
 耐温/ Temperature: -35°C-90°C
 标准/Standard: SGS/ROHS
 适用LED型号/LED series: 3535/3030

HH-HW17-20H

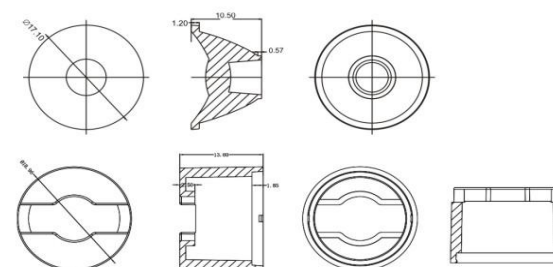

规格/ Specification: 17mm
 角度/ lens angle: 20°30°45° 60°90°
 灯芯数/Wick: 1
 材料/Material: PMMA
 透过率/ Transmittance: 93%
 耐温/ Temperature: -35°C-120°C
 标准/Standard: SGS/ROHS
 适用LED型号/LED series: 仿流明

HH-01-2008G-XP

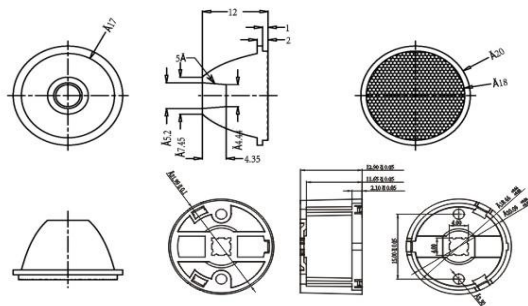

规格/ Specification: 20mm
 角度/ lens angle: 8°15°30°45°60°85°10×60° 30×60°
 灯芯数/Wick: 1
 材料/Material: PMMA
 透过率/ Transmittance: 93%
 耐温/ Temperature: -35°C-90°C
 标准/Standard: SGS/ROHS
 适用LED型号/LED series: 3535/3030

HH-HW20-20H

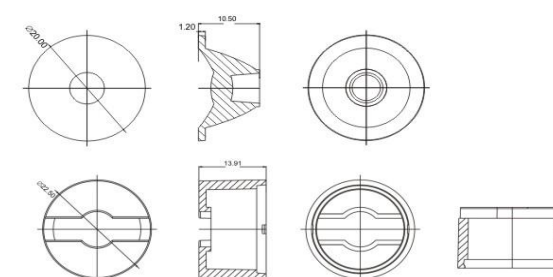

规格/ Specification: 20mm
 角度/ lens angle: 20°30°45° 60°90°
 灯芯数/Wick: 1
 材料/Material: PMMA
 透过率/ Transmittance: 93%
 耐温/ Temperature: -35°C-120°C
 标准/Standard: SGS/ROHS
 适用LED型号/LED series: 仿流明

HH-20-15-TWH

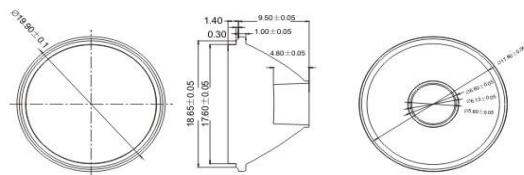

规格/ Specification: 20mm
 角度/ lens angle: 8°10°15° 25°30°45°60°90°
 灯芯数/Wick: 1
 材料/Material: PMMA

透过率/ Transmittance: 93%
 耐温/ Temperature: -35°C-90°C
 标准/Standard: SGS/ROHS
 适用LED型号/LED series: 仿流明

HH-P17-20G-XML

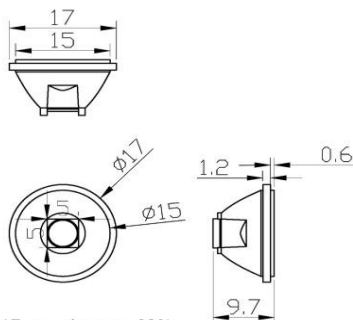

规格/ Specification: 17mm
 角度/ lens angle: 20°30°45°60°70°
 灯芯数/Wick: 1
 材料/Material: PMMA

透过率/ Transmittance: 93%
 耐温/ Temperature: -35°C-90°C
 标准/Standard: SGS/ROHS
 适用LED型号/LED series: XML 5050

HH-P20-15G-XML

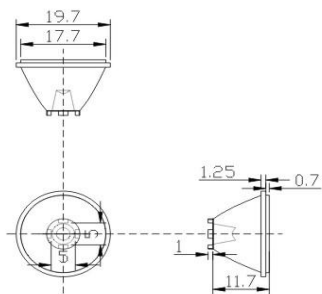

规格/ Specification: 20mm
 角度/ lens angle: 15°30°45°60°
 灯芯数/Wick: 1
 材料/Material: PMMA

透过率/ Transmittance: 93%
 耐温/ Temperature: -35°C-90°C
 标准/Standard: SGS/ROHS
 适用LED型号/LED series: XML 5050

室内照明 Indoor lighting



HH-JC35-13-30



规格/ Specification: 35mm
角度/ lens angle: 30°45°
灯芯数/Wick: 1
材料/Material: PMMA

透过率/ Transmittance: 93%
耐温/ Temperature: -35°C-120°C
标准/Standard: SGS/ROHS
适用LED型号/LED series: COB

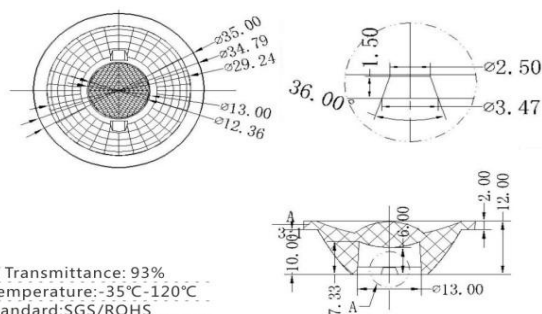

HH-JC46-23-30HM



规格/ Specification: 46mm
角度/ lens angle: 30°
灯芯数/Wick: 1
材料/Material: PMMA

透过率/ Transmittance: 93%
耐温/ Temperature: -35°C-90°C
标准/Standard: SGS/ROHS
适用LED型号/LED series: COB

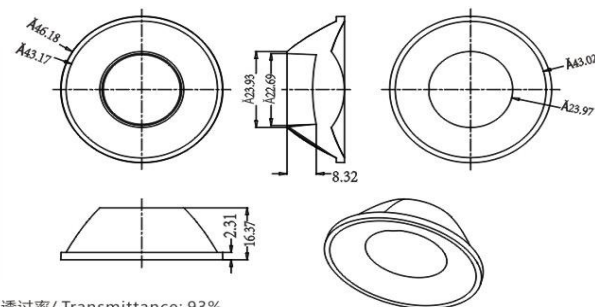

HH-13-40-13-25



规格/ Specification: 40mm
角度/ lens angle: 25°38°
灯芯数/Wick: 1
材料/Material: PMMA

透过率/ Transmittance: 93%
耐温/ Temperature: -35°C-120°C
标准/Standard: SGS/ROHS
适用LED型号/LED series: COB

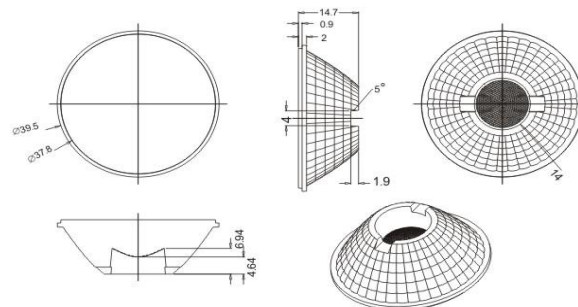

HH-70-7515



规格/ Specification: 75mm
角度/ lens angle: 10°15'24°38°
灯芯数/Wick: 1
材料/Material: PMMA

透过率/ Transmittance: 93%
耐温/ Temperature: -35°C-90°C
标准/Standard: SGS/ROHS
适用LED型号/LED series: COB

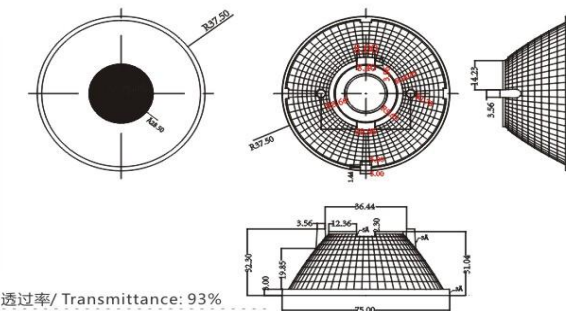

HH-JC43-21-40HM



规格/ Specification: 43mm
角度/ lens angle: 40°
灯芯数/Wick: 1
材料/Material: PMMA

透过率/ Transmittance: 93%
耐温/ Temperature: -35°C-90°C
标准/Standard: SGS/ROHS
适用LED型号/LED series: COB

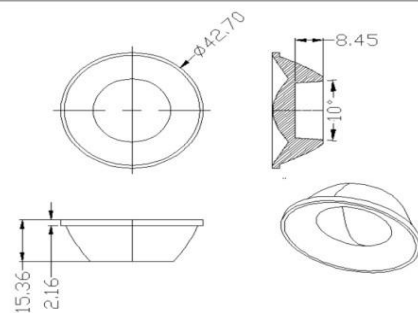

HH-38DT



规格/ Specification: 8.5MM 12.5MM 16MM 19MM 23MM 27.7MM 29MM 35.8MM 38MM 44.8MM 60MM
角度/ lens angle: 5°~60°
灯芯数/Wick: 1
材料/Material: PMMA

透过率/ Transmittance: 93%
耐温/ Temperature: -35°C-120°C
标准/Standard: SGS/ROHS
适用LED型号/LED series: 3535/3030/5050

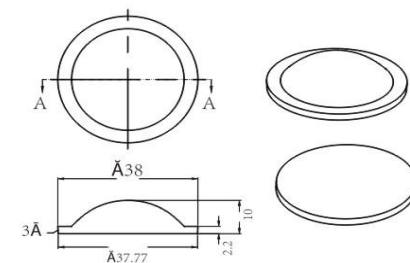

HH-P03B-2515G-XP



规格/ Specification: 25mm
角度/ lens angle: 15°30°45°60°
灯芯数/Wick: 3
材料/Material: PMMA

透过率/ Transmittance: 93%
耐温/ Temperature: -35°C-90°C
标准/Standard: SGS/ROHS
适用LED型号/LED series: 3535/3030

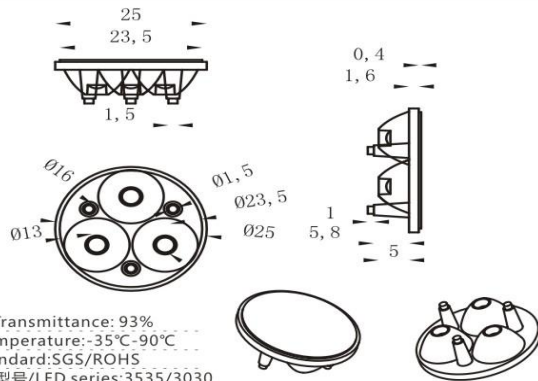

HH-P50MM



规格/ Specification: 50mm
角度/ lens angle: 10°15°25°30°38°45°60°
灯芯数/Wick: 3/4/5
材料/Material: PC

透过率/ Transmittance: 93%
耐温/ Temperature: -35°C-90°C
标准/Standard: SGS/ROHS
适用LED型号/LED series: 3535

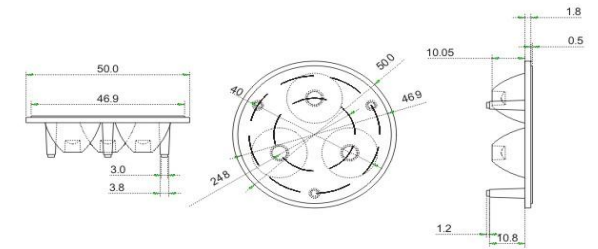

HH-P35MM



规格/ Specification: 35mm
角度/ lens angle: 15°25°30°38°45°60°
灯芯数/Wick: 3/4/5/7
材料/Material: PMMA

透过率/ Transmittance: 93%
耐温/ Temperature: -35°C-90°C
标准/Standard: SGS/ROHS
适用LED型号/LED series: 3535/3030

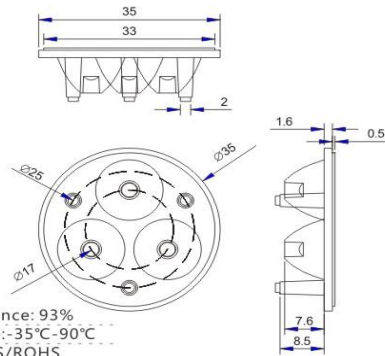

HH-P67MM



规格/ Specification: 67mm
角度/ lens angle: 15°25°30°38°45°60°
灯芯数/Wick: 6/7/9/12/15/18/24/30/36
材料/Material: PMMA

透过率/ Transmittance: 93%
耐温/ Temperature: -35°C-90°C
标准/Standard: SGS/ROHS
适用LED型号/LED series: 3535

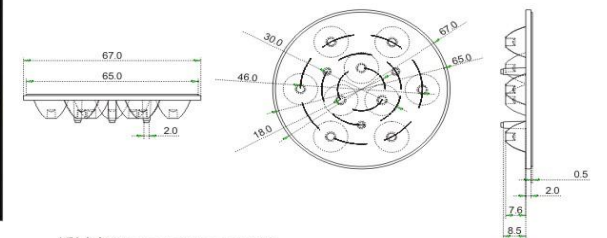

HH-P45MM



规格/ Specification: 45mm
角度/ lens angle: 15°25°30°38°45°60°
灯芯数/Wick: 3/4/5/7/9/12
材料/Material: PMMA

透过率/ Transmittance: 93%
耐温/ Temperature: -35°C-90°C
标准/Standard: SGS/ROHS
适用LED型号/LED series: 3535/3030

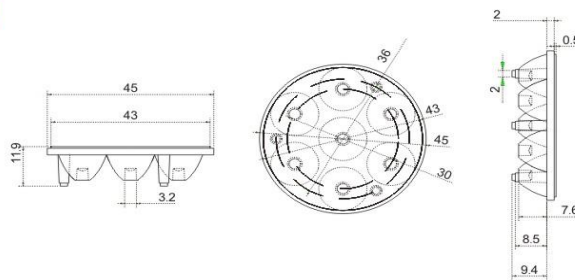

HH-P92MM



规格/ Specification: 92mm
角度/ lens angle: 10°15°25°30°38°45°60°
灯芯数/Wick: 9/12
材料/Material: PMMA

透过率/ Transmittance: 93%
耐温/ Temperature: -35°C-90°C
标准/Standard: SGS/ROHS
适用LED型号/LED series: 3535

